

1 Parts description

See the operation detail on Super B Website:

<https://www.superbiketool.com/>

Click:Product → Product list → Work stands → TB-WS65

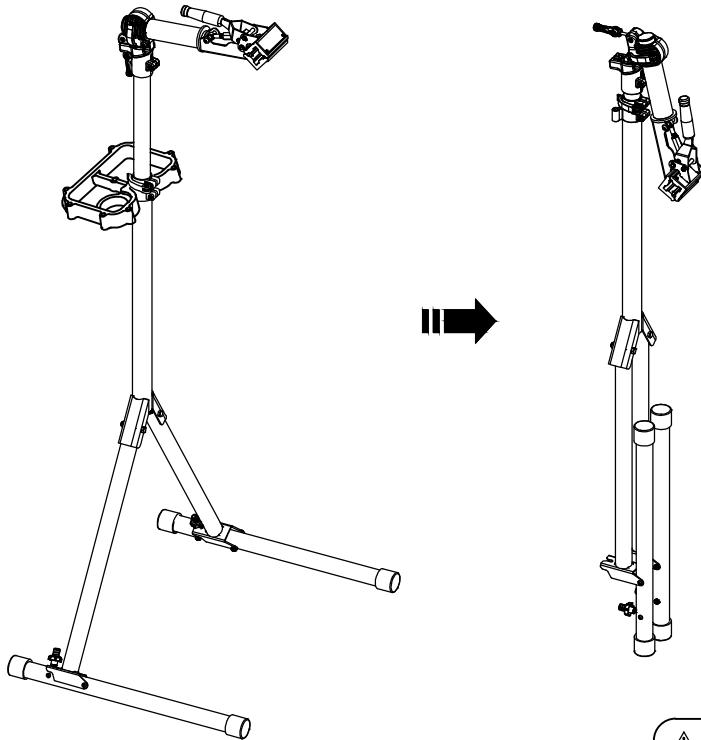

NO.	PART	Q'TY
①	Clamp	1
②	Tool tray	1
③	Main body	1
④	Right leg	1
⑤	Left leg	1
⑥	M8 screw	2
⑦	M8 nut	2
⑧	Leveling end cap	4

⚠ Max load 40kg, suits for heavy bikes

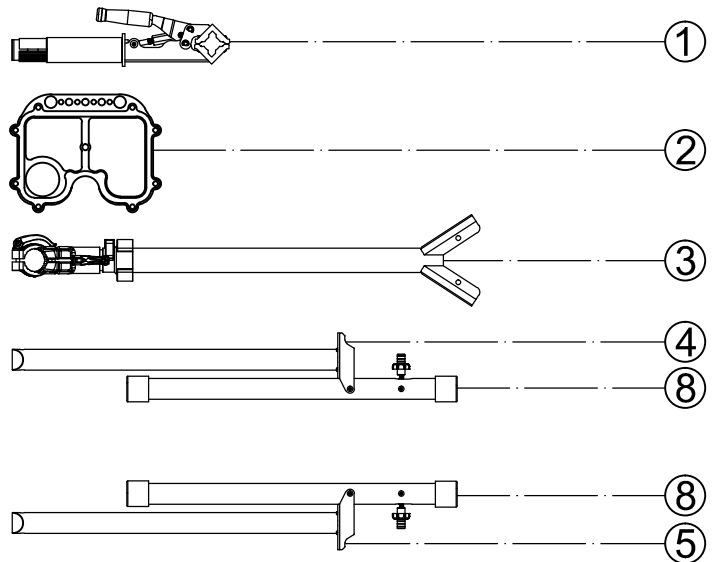
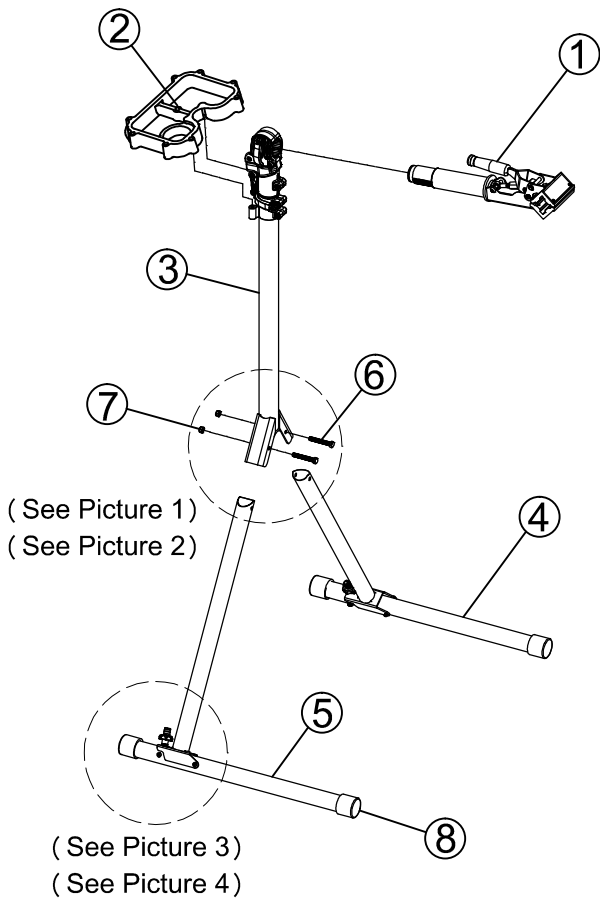

(Packed in a bag)

- ⑥
- ⑦
- ⑥ M8 screw *2
- ⑦ M8 nut *2

2 Leg assembly

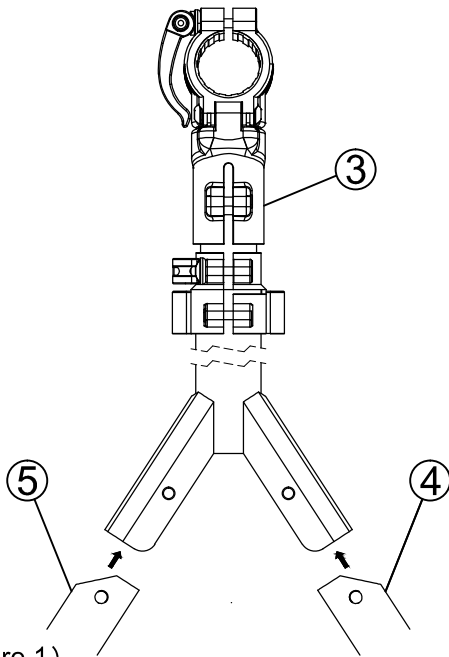

(Picture 1)

1. The legs ④ ⑤ insert (bevel side must be upward) to mainbody ③ (As picture 1).

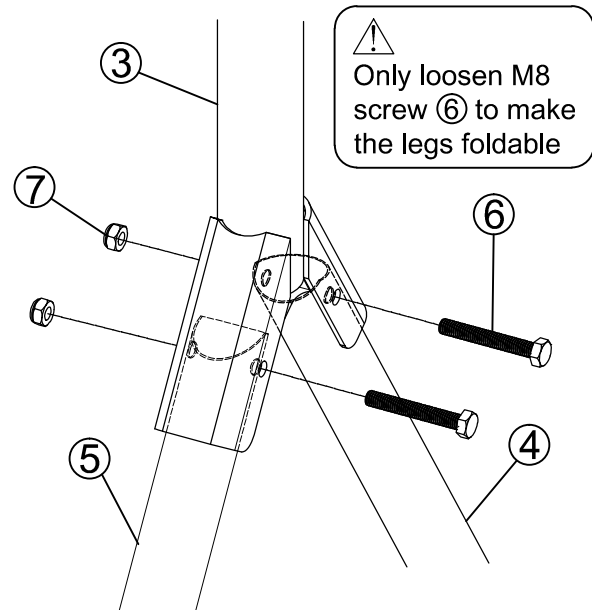

(Picture 2)

2. Put M8 screw ⑥ and M8 nut ⑦ in right position and tighten with two 13mm open ended spanners until mainbody ③ and legs ④ ⑤ connect properly (As picture 2)

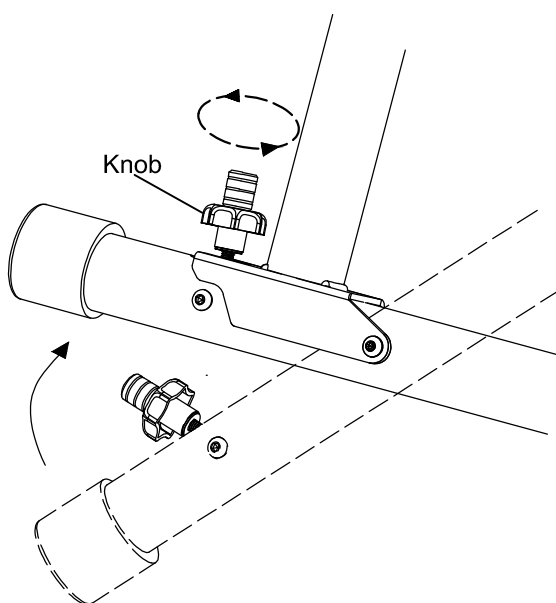

(Picture 3)

3. Rotate the knob to tighten the leg ④ ⑤ (As picture 3)

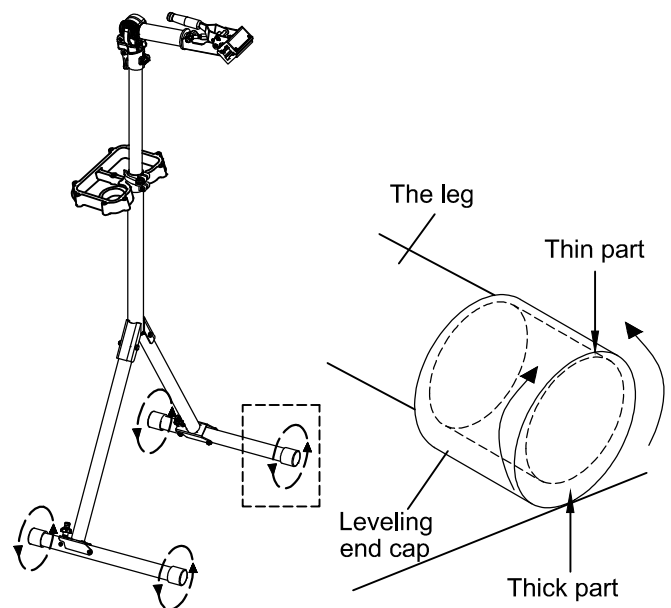

(Picture 4)

4. Adjust the direction of leveling end cap ⑧ to level the work stand on uneven ground. (As picture 4)

3 Clamp assembly

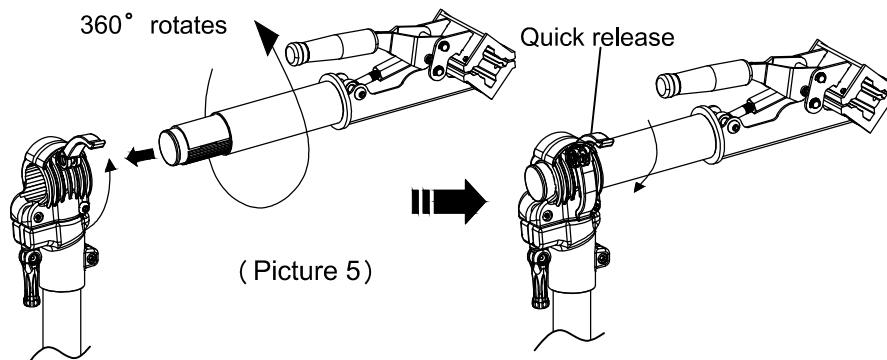

4 Clamp folding instruction

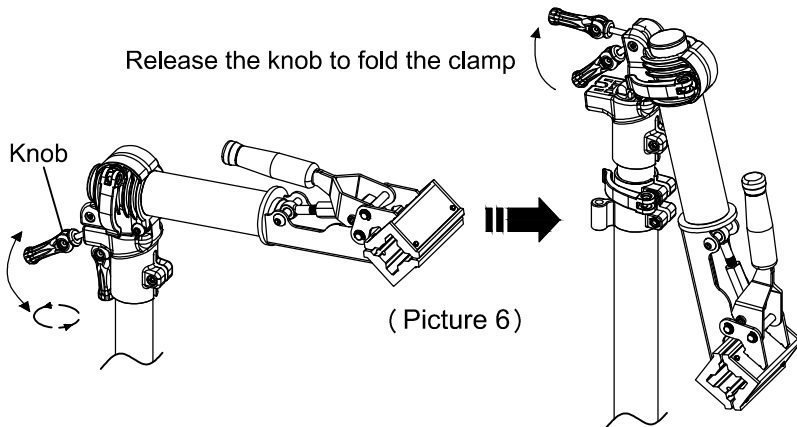

5 Tool tray assembly

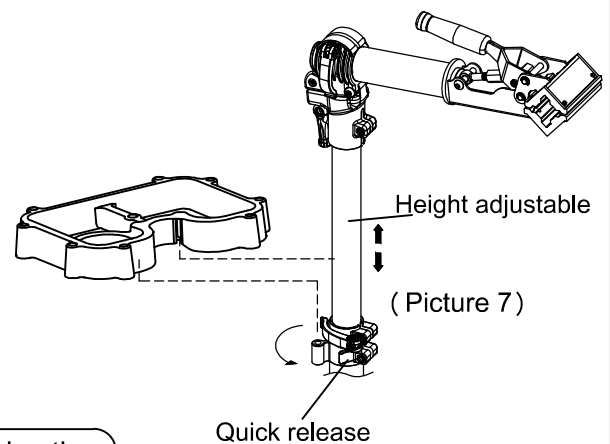

⚠ Ensure to secure the clamp by tightening the knob before starting to work

6 Adjust the clamp

1. Pull up the handle to open the clamp. (See picture 8)
2. Place the frame into the opening of the clamp (it could be the top tube, seat tube and standing tube) and adjust the hex adjusting shaft to proper position then press down the handle to hold the frame.

Adjustment:

- 2-1. Rotate the hex adjusting shaft clockwise to tighten the clamp properly, making the opening of the clamp smaller. (See picture 9)
- 2-2. Rotate the hex adjusting shaft counter-clockwise to loosen the clamp properly, making the opening of the clamp bigger. (See picture 9)

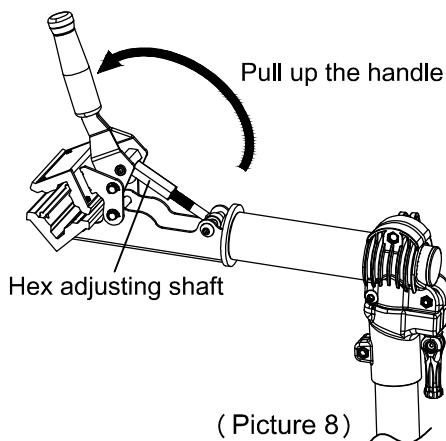

⚠ To be sure the tube is tightened before work

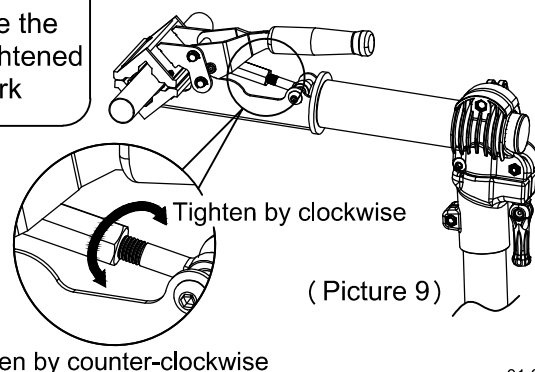

1 零件說明

詳細操作影片請至Super B官網 <http://www.superbiketool.com/> 觀看，點擊Product ➡ Product list ➡ Work stands ➡ TB-WS65

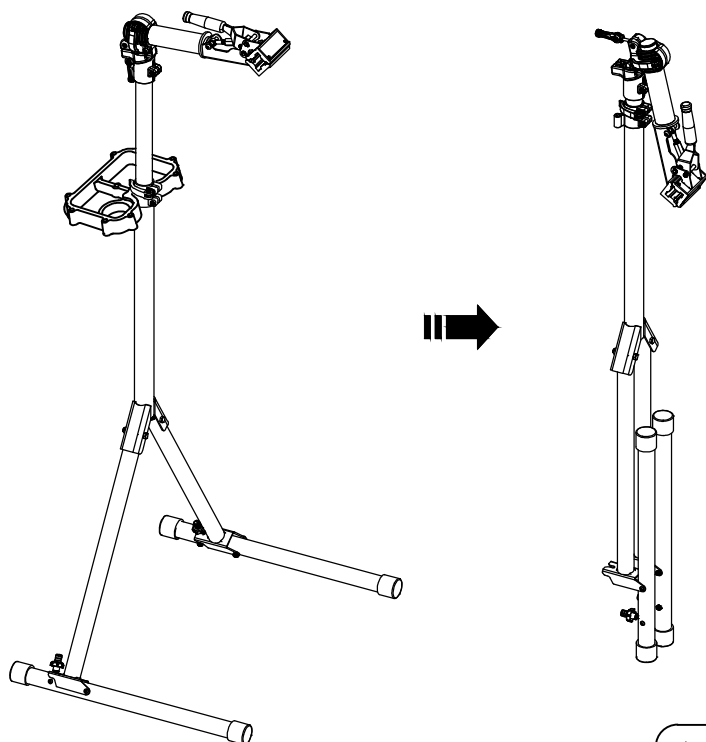

項次	名稱	數量
①	夾頭	1
②	工具盤	1
③	主體	1
④	右腳管	1
⑤	左腳管	1
⑥	M8螺絲	2
⑦	M8尼龍螺帽	2
⑧	偏心管塞	4

⚠ 最大載重40kgs，可承載重型車架

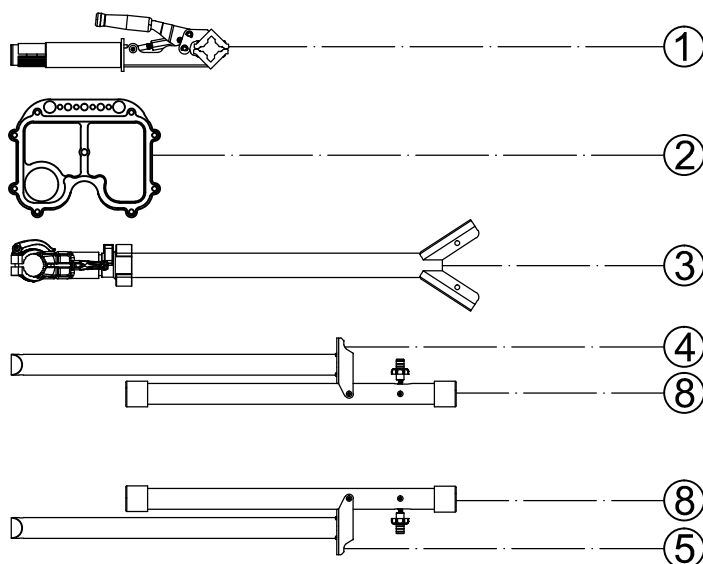
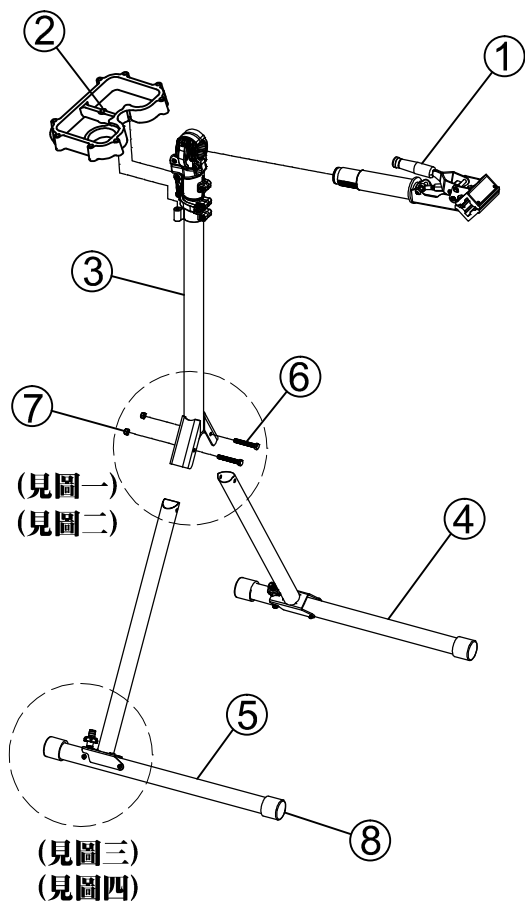

(此框內零件一個袋子包裝)

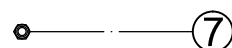
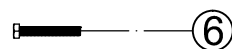

⑥ M8螺絲*2

⑦ M8尼龍螺帽*2

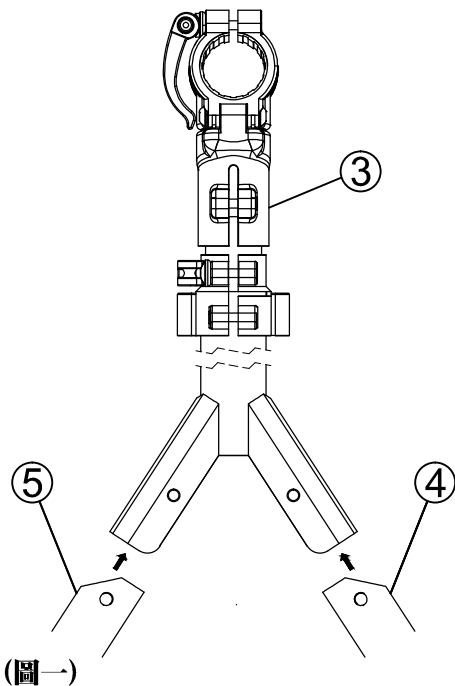
2 腳管組裝說明

1. 腳管 ④ ⑤ 與主體 ③ 組裝時，斜面需朝上再鎖入，以確保產品操作無虞。(如圖一所示)

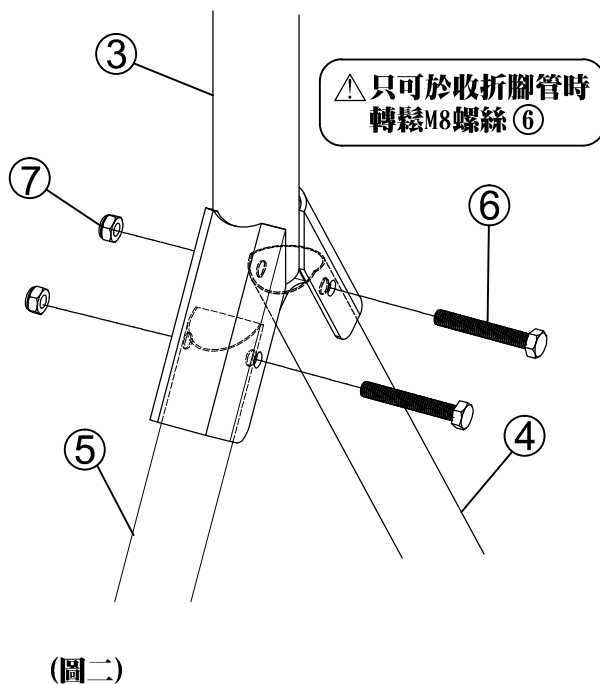

2. 將M8螺絲 ⑥ 與M8螺帽 ⑦ 對準裝入，並以兩支13mm開口扳手鎖緊，直到主體 ③ 與腳管 ④ ⑤ 穩固結合。(如圖二所示)

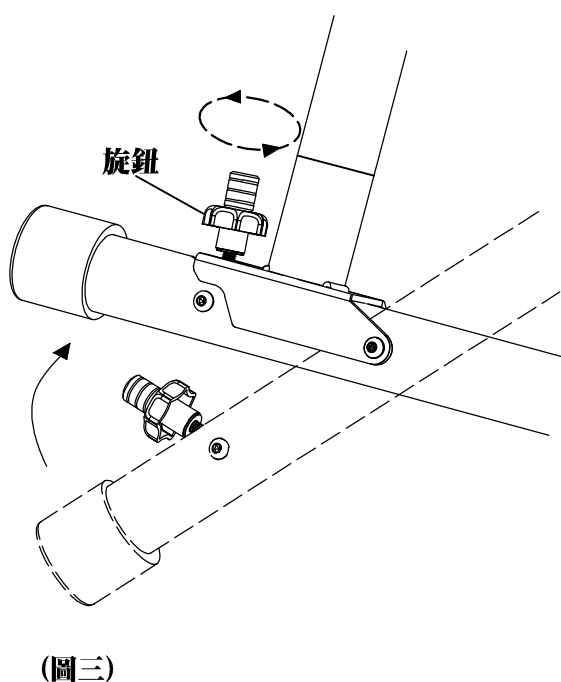

3. 轉動旋鈕以放鬆或固定腳管 ④ ⑤。(如圖三所示)

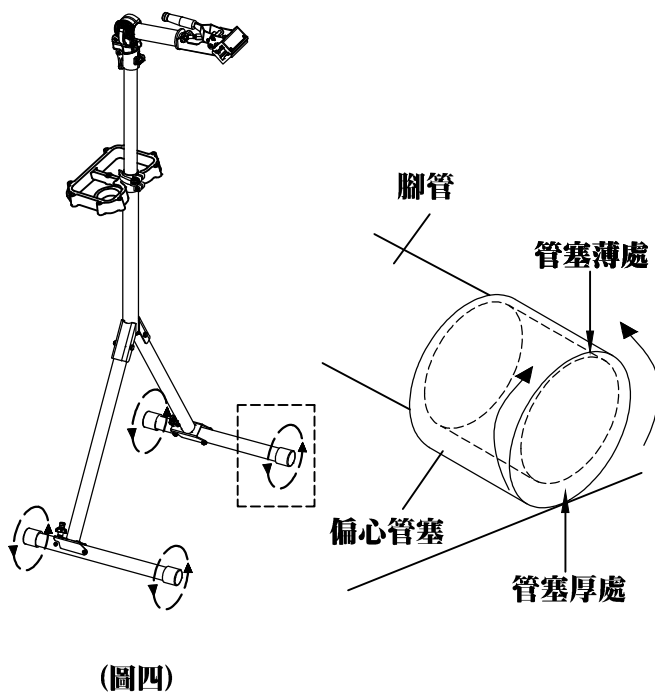

4. 請依照自身工作環境的地形調整偏心管塞 ⑧，以確保操作時修車架更穩定。(如圖四所示)

3 夾頭組裝說明

夾頭可360°旋轉

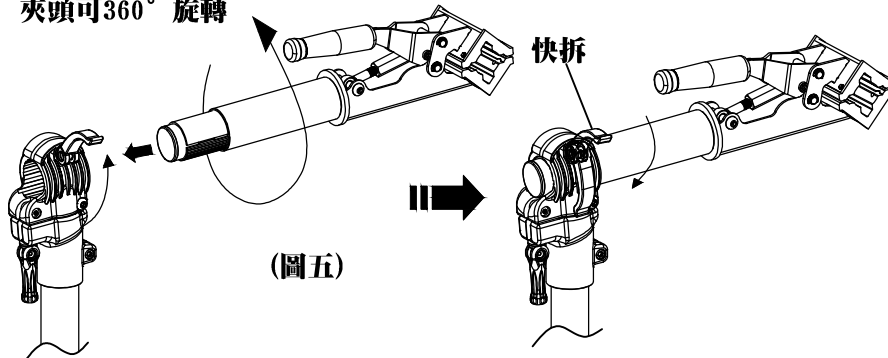

4 夾頭收折說明

將旋柄放鬆,可收折夾頭

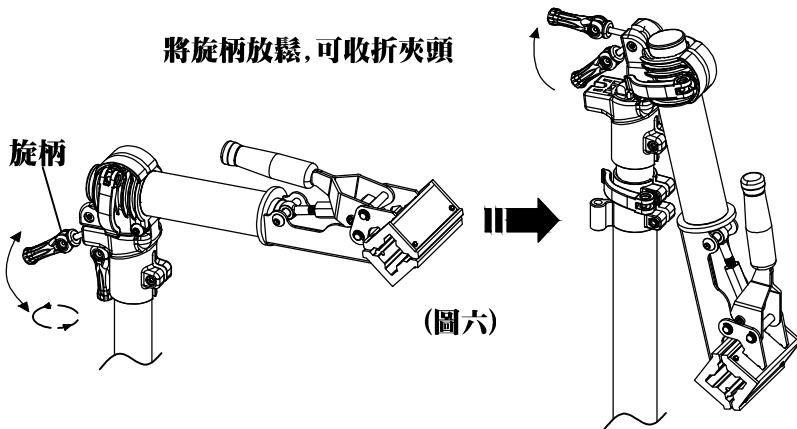

5 工具盤組裝說明

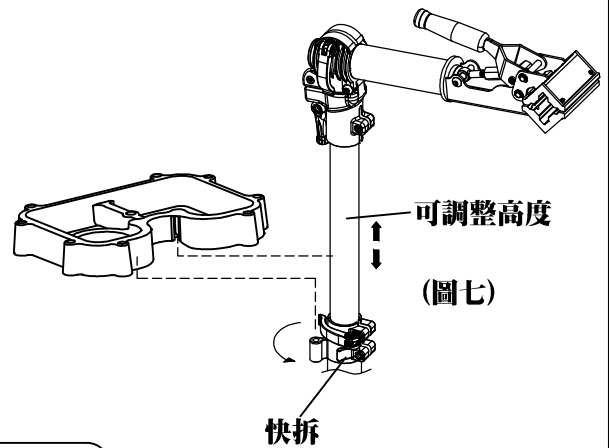

 使用本產品前,務必旋緊旋柄,以固定夾頭

6 夾頭開口調整方式

1. 上拉握把, 打開夾頭。(如圖八所示)
2. 將車管(可選擇車架上管/立管/座管)放入夾頭開口, 並依車管尺寸將六角調整軸旋轉至適當位置, 再將握把下壓固定車管。

調整方式:

1. 依圖所示將六角調整軸順時針旋轉, 可適度鎖緊夾頭, 使夾頭開口變小。(如圖九所示)
2. 依圖所示將六角調整軸逆時針旋轉, 可適度放鬆夾頭, 使夾頭開口變大。(如圖九所示)

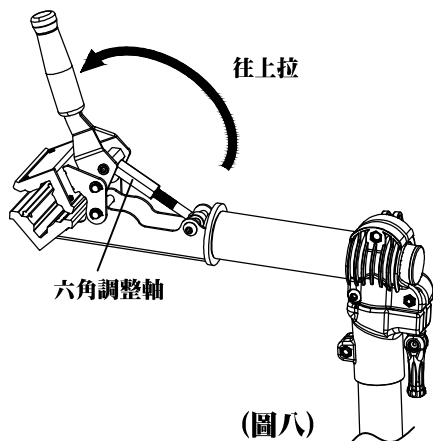

 使用時, 務必確認已夾緊車管再執行工作

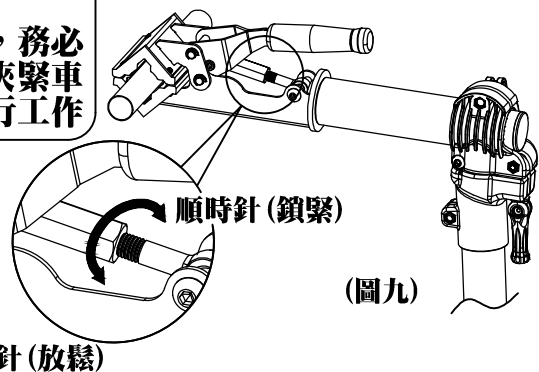

1 Beschreibung der Teile

Einzelheiten zur Bedienung finden Sie auf der Super B website: <https://www.superbiketool.com/>
Unter: Product → Product list → Work stands → TB-WS65

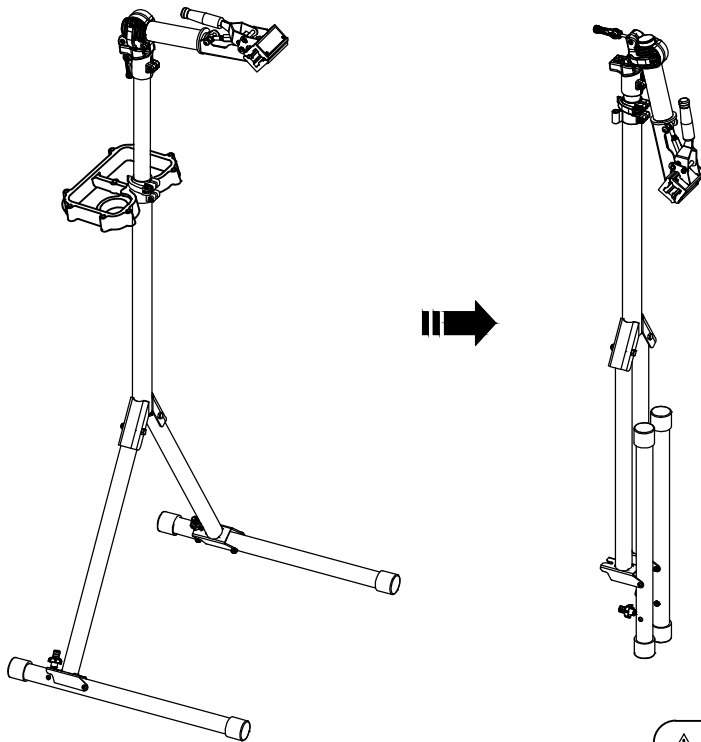

Nr.	Teil	Stk.
①	Klemme	1
②	Werkzeugablage	1
③	Hauptteil	1
④	Rechter Standfuß	1
⑤	Linker Standfuß	1
⑥	M8 Schraube	2
⑦	M8 Mutter	2
⑧	Endkappe	4

⚠ Max Gewicht 40 kg, geeignet für schwere Fahrräder

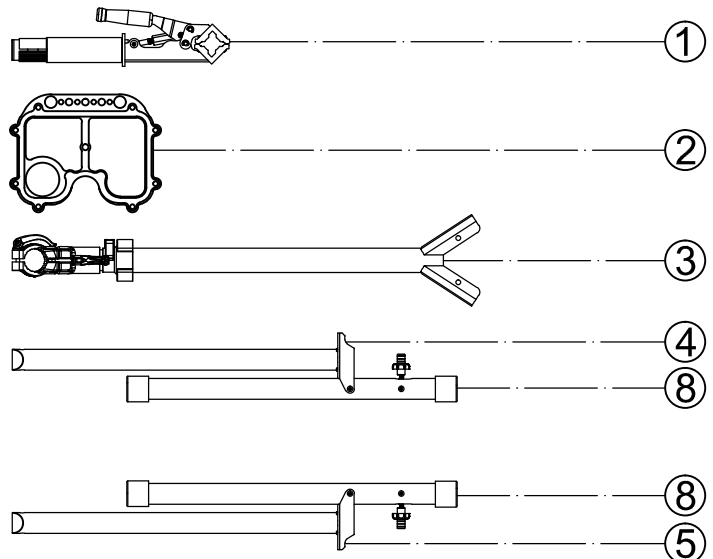
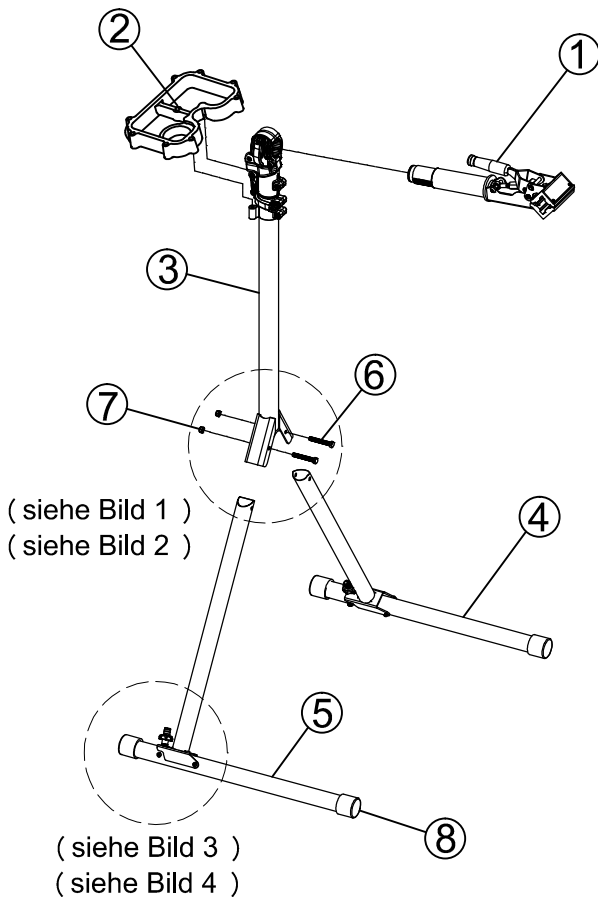

(Beutelinhalt)

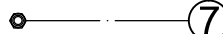
-  ⑥
-  ⑦
- ⑥ M8 Schrauben *2
- ⑦ M8 Muttern *2

2 Montage der Füße

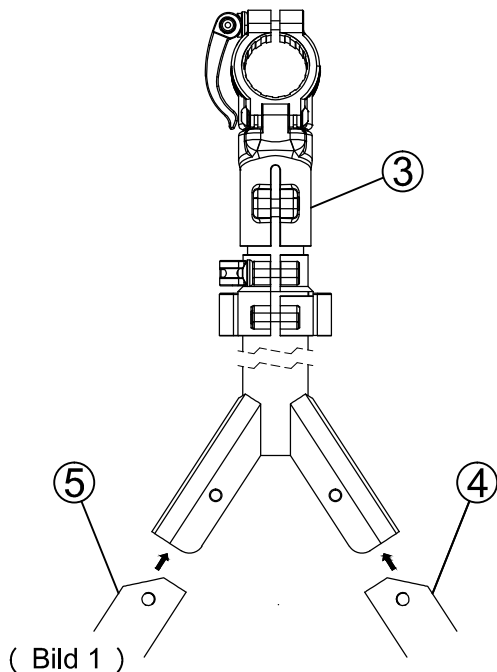

1. Die Beine ④ ⑤ (Ebene Seite nach oben) in den Hauptteil ③ einführen (wie Bild 1).

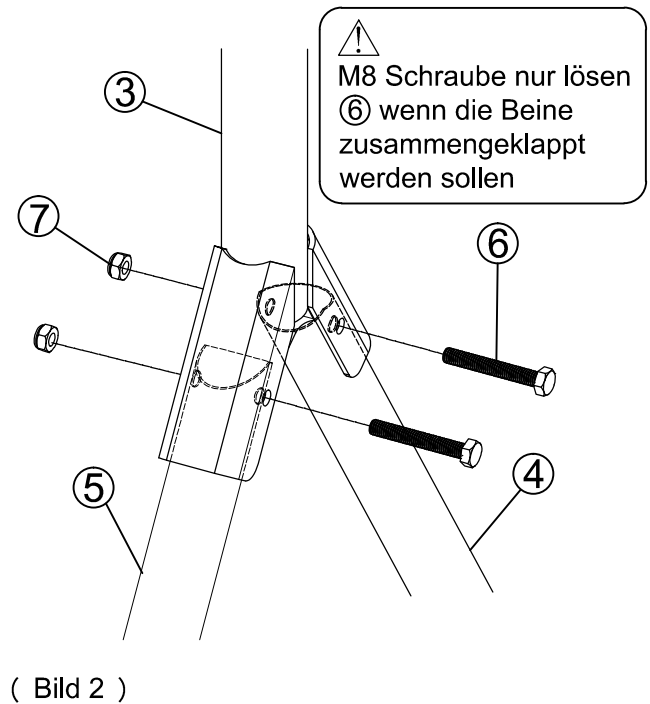

2. M8 Schraube ⑥ und M8 Mutter ⑦ einbauen und mit 13mm Schlüssel anziehen ③ bis die Füße ④ ⑤ und Hauptteil verbunden sind (wie Bild 2).

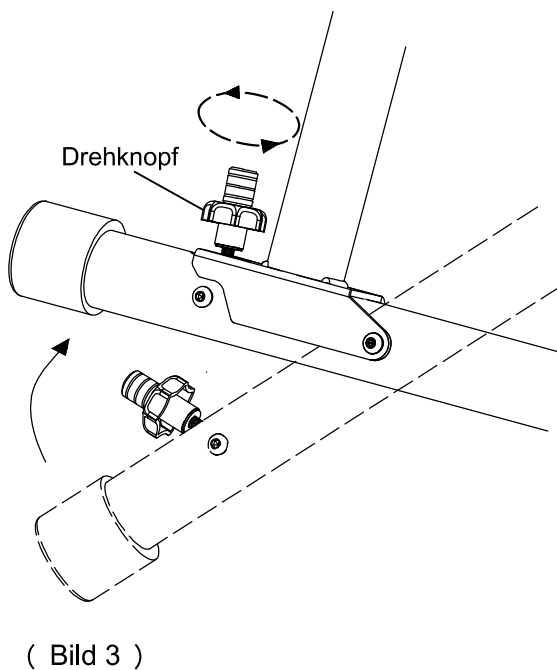

3. Drehknopf festdrehen um die Beine zu fixieren ④ ⑤ (wie Bild 3)

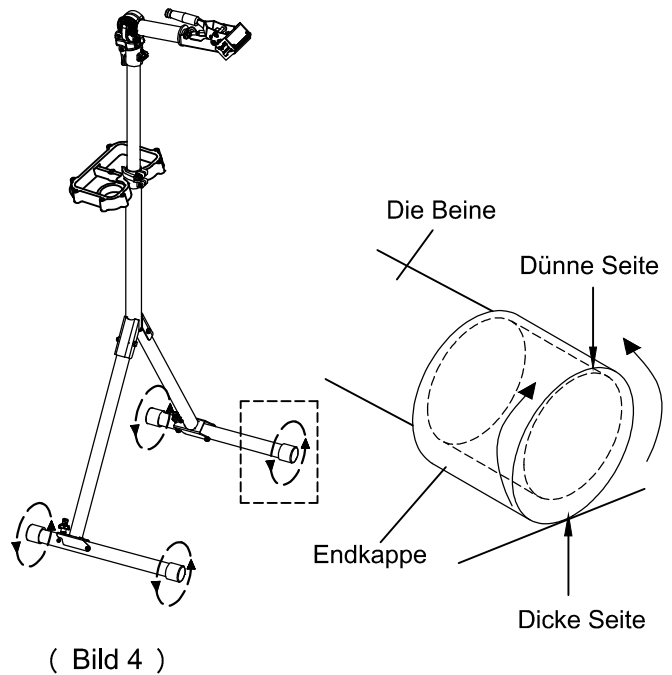

4. Endkappe einstellen um Unebenheiten auf dem Boden auszugleichen (wie Bild 4)

3 Aufbau der Klemme

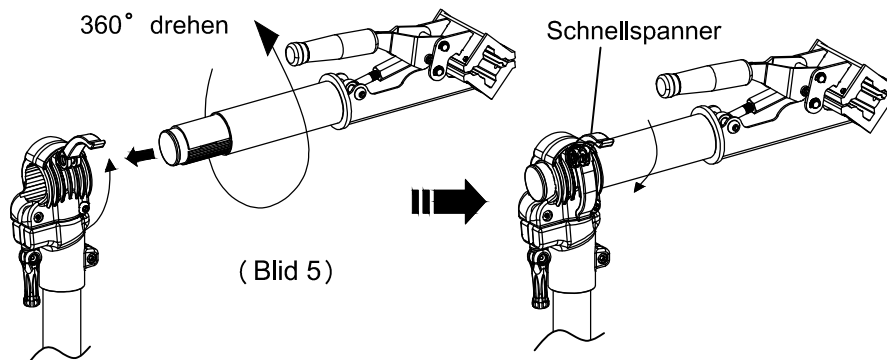

4 Klemmhalter einklappen

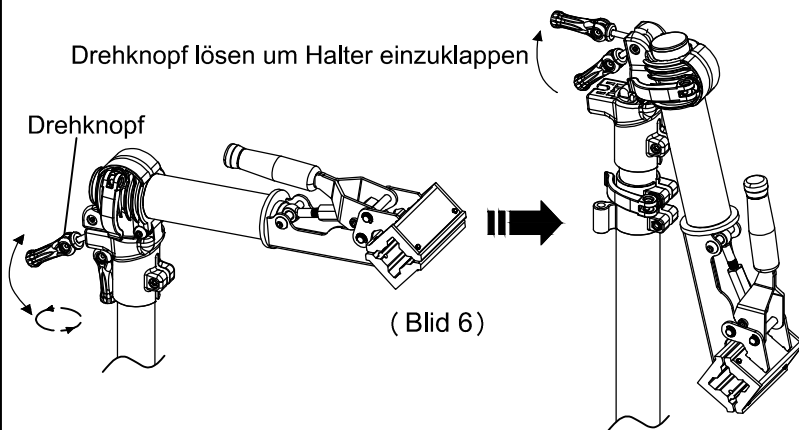

5 Ablage anbauen

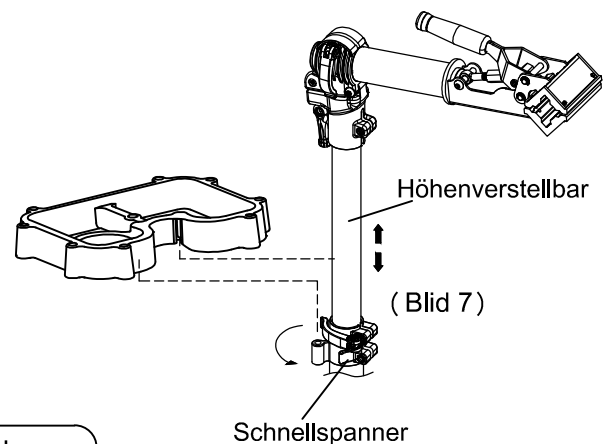

⚠ Klemme sichern Drehknopf anziehen bevor mit den Arbeiten begonnen wird!

6 Klemme justieren

1. Griff hochziehen zum öffnen der Klemme. (siehe Bild 8)
2. Rahmen / Fahrrad in die Öffnung hängen (Oberrohr, Sitzrohr oder Sattelstütze), Sechskant Einstellstift richtig einstellen, Griff herunter drücken um den das Rad fest zu halten.

Einstellung:

- 2-1 Sechskant Einstellstift im Uhrzeigersinn drehen, um die Klemme zu spannen, die Öffnung der Klemme wird kleiner. (siehe Bild 9)
- 2-2. Sechskant Einstellstift gegen den Uhrzeigersinn drehen, um die Klemme zu lockern / öffnen, die Öffnung der Klemme wird größer (siehe Bild 9)

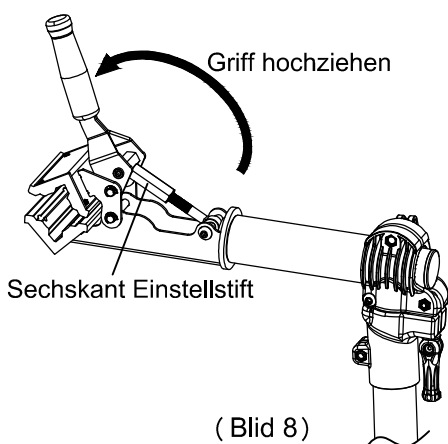

⚠ Stellen Sie sicher das der Rahmen / das Rad fest im Montagegeständer sitzt und die Klemme geschlossen ist !

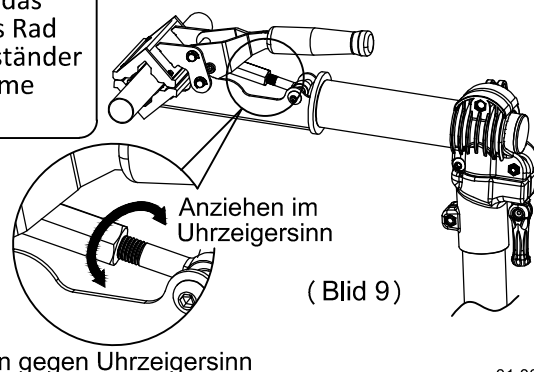

1 Description des pièces

Voir le détail du montage sur le site web de Super B :

<https://www.superbiketool.com/>

Clic: Produit ➔ Liste produit ➔ Pied d'atelier ➔ TB-WS65

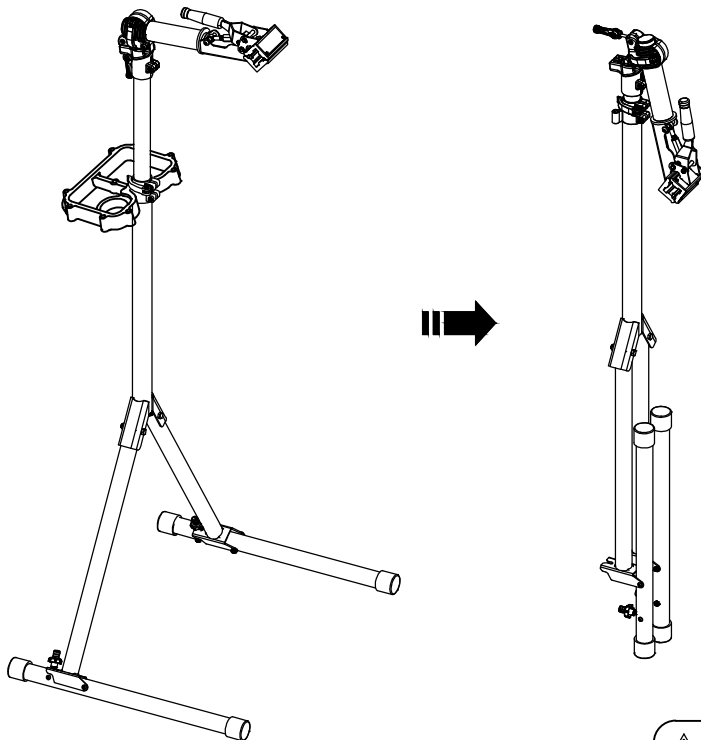

No	Pièces	Qtés
①	Pince	1
②	Plateau à outils	1
③	Corps principal	1
④	Jambe droite	1
⑤	Jambe gauche	1
⑥	Vis M8	2
⑦	Ecrou M8	2
⑧	Embout de mise à niveau	4

⚠ Charge max. 40 kg, convient aux vélos lourds

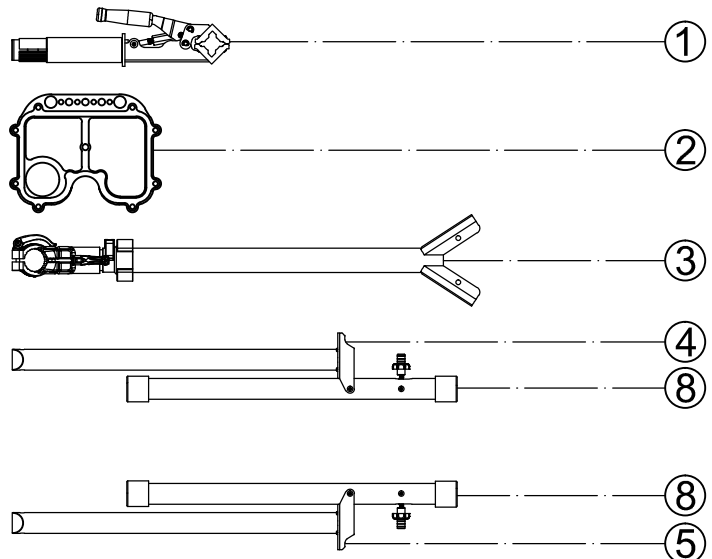
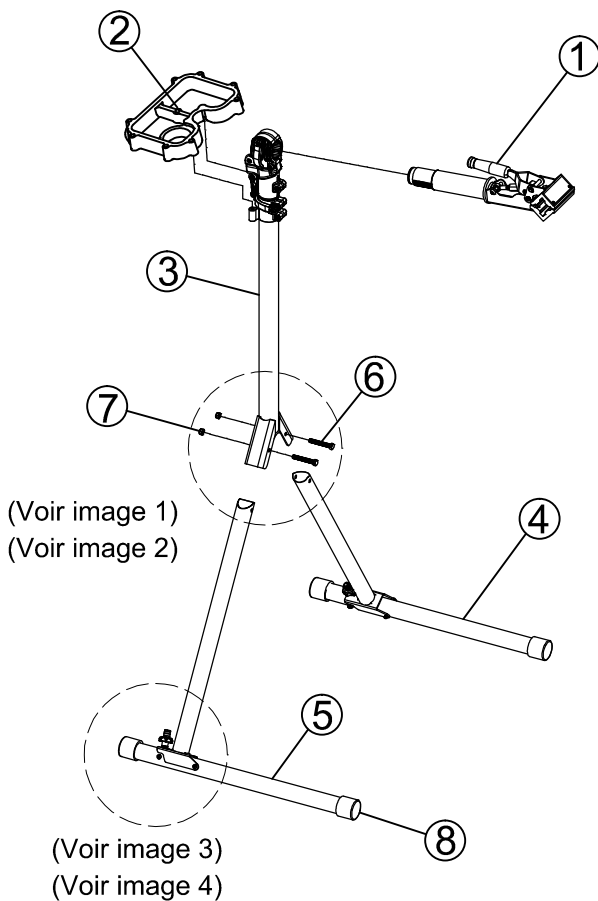

(Emballé en sachet)

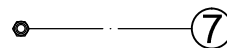
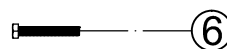

⑥ Vis M8 *2

⑦ Ecrou M8 *2

2 Assemblage des jambes

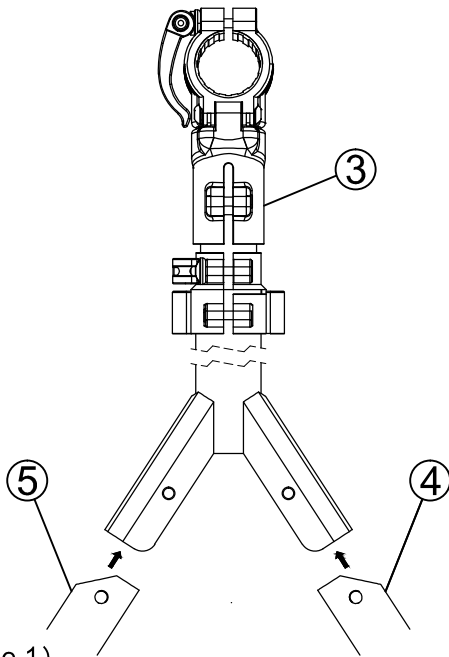

(Image 1)

1. Les jambes ④ ⑤ s'insèrent (le côté biseauté doit être vers le haut) dans le corps principal ③
(Comme image 1).

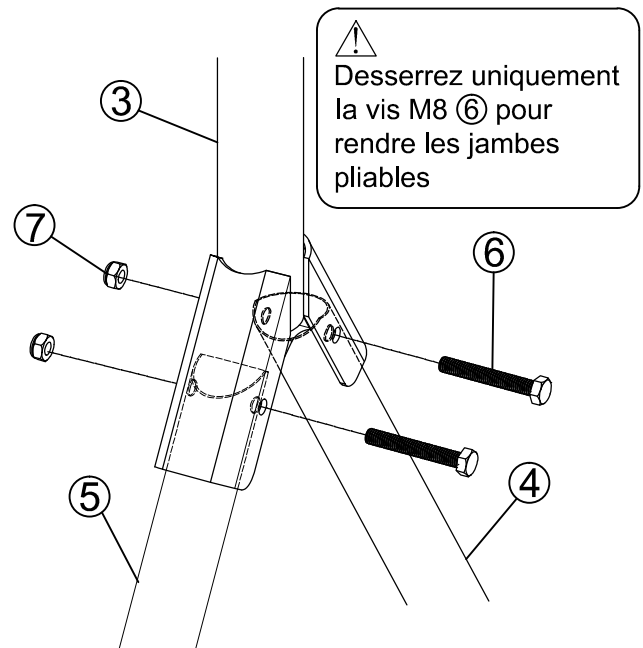

(Image 2)

2. Mettez la vis M8 ⑥ et l'écrou M8 ⑦ dans la bonne position et serrez avec 2 clés plates de 13mm jusqu'à ce que le corps principal ③ et les jambes ④ ⑤ se connectent correctement (comme image 2)

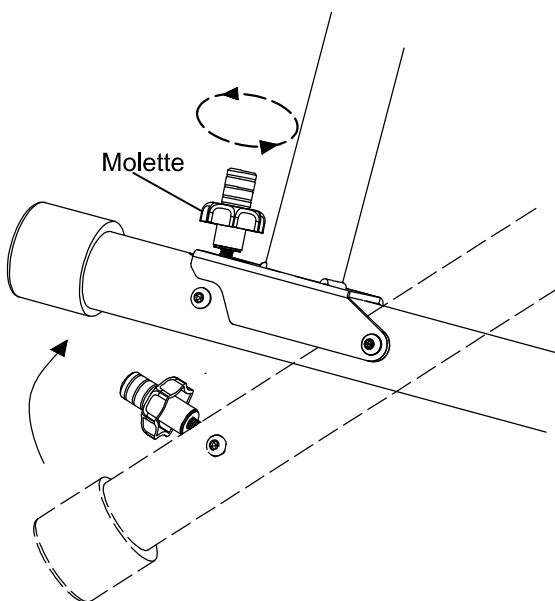

(Image 3)

3. Tourner la molette pour serrer la jambe ④ ⑤
(Comme image 3).

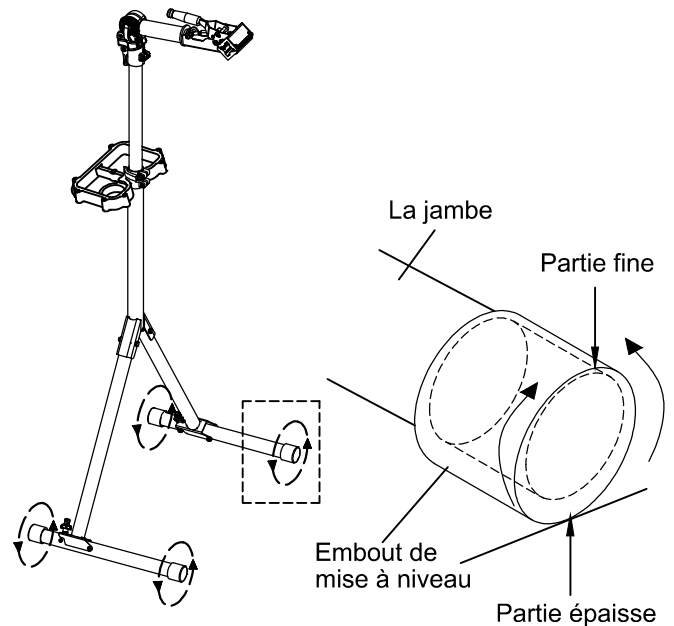

(Image 4)

4. Ajustez l'embout de mise à niveau pour niveler le pied d'atelier sur un sol irrégulier. (Comme image 4)

3 Assemblage de la pince

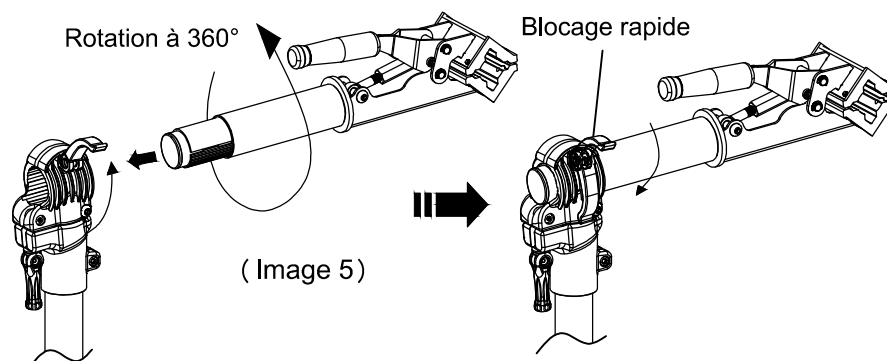

4 Instruction de pliage de la pince

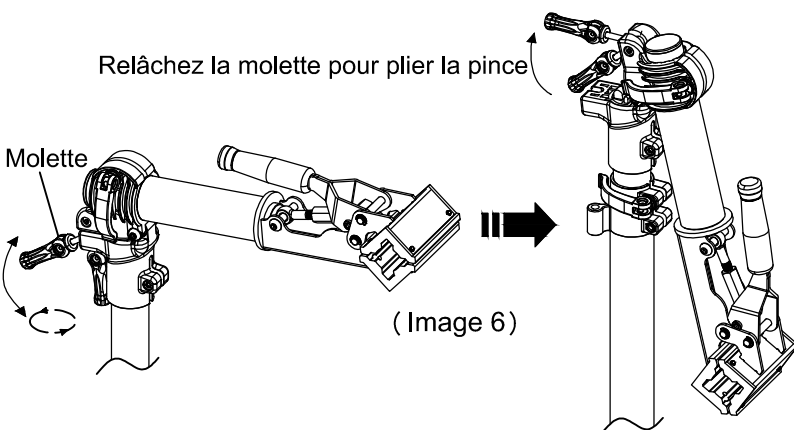

5 Assemblage du plateau à outils

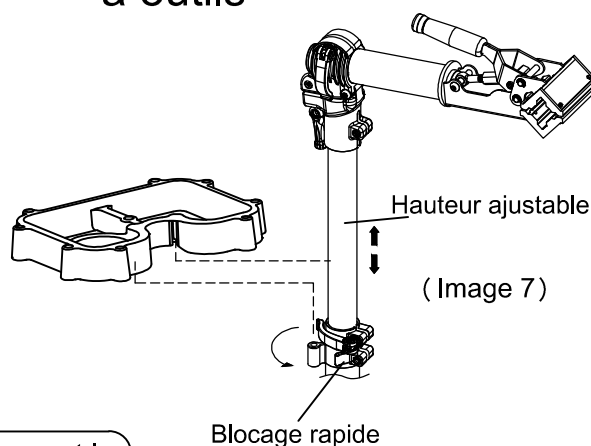

⚠ Assurez-vous de bloquer la pince en serrant la molette avant de commencer à travailler

6 Ajustez la pince

1. Tirez sur la poignée pour ouvrir la pince. (Voir image 8)
2. Placez le cadre dans l'ouverture de la pince (cela peut être le tube supérieur, le tube de selle ou le tube vertical) et ajustez l'écrou de réglage hexagonal à la bonne position, puis appuyez sur la poignée pour maintenir le cadre.

Réglage :

- 2-1. Faites tourner l'écrou de réglage hexagonal dans le sens des aiguilles d'une montre pour serrer correctement la pince, ce qui réduit l'ouverture de la pince. (Voir image 9)
- 2-2. Faites tourner l'écrou de réglage hexagonal dans le sens inverse des aiguilles d'une montre pour desserrer correctement la pince, ce qui agrandit l'ouverture de la pince.

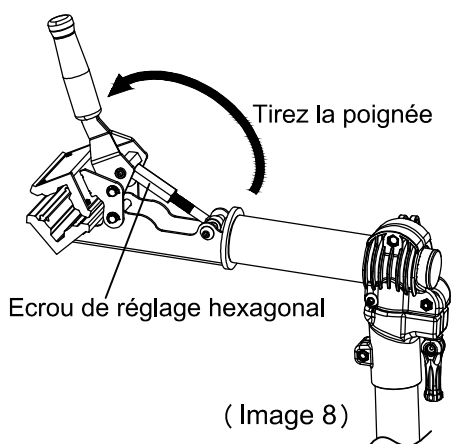

Assurez-vous que le tube est serré avant de travailler

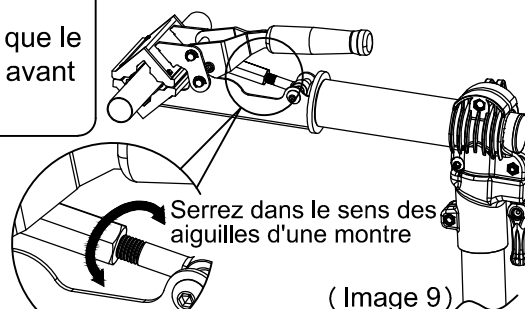

Desserrez dans le sens inverse des aiguilles d'une montre