

1 Parts description

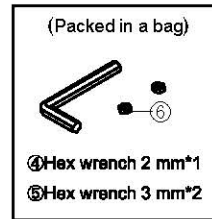
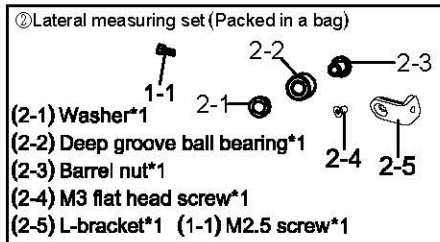
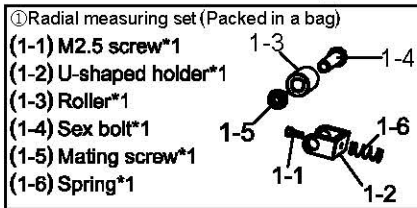
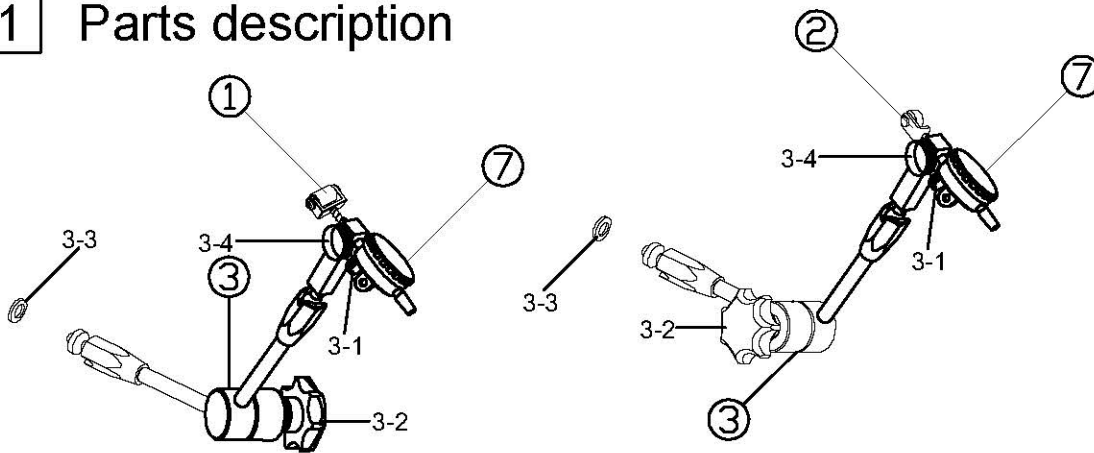

NO	PARTS	QTY
①	Radial measuring set	1
1-1	M2.5 screw	1
1-2	U-shaped holder	1
1-3	Roller	1
1-4	Sex bolt	1
1-5	Mating screw	1
1-6	Spring	1
②	Lateral measuring set	1
1-1	M2.5 screw	1
2-1	Washer	1
2-2	Deep groove ball bearing	1
2-3	Barrel nut	1
2-4	M3 flat head screw	1
2-5	L-bracket	1
③	All-purpose arm	2
3-1	Fine-tuning knob	2
3-2	Knob	2
3-3	Spacer	2
3-4	Dial indicator knob	2
④	Hex wrench 2 mm	1
⑤	Hex wrench 3 mm	2
⑥	M8 nut	2
⑦	Dial indicator	2

2 Assembly

- Loosen the dial indicator knob (3-4), set the two dial indicators ⑦ separately on all-purpose arms ③, and then tighten the dial indicator knob (3-4). (see picture 1)
- Assemble the radial measuring set ① on dial indicator ⑦.
 - Remove the contact point of the right dial indicator ⑦.
 - Assemble M2.5 screw (1-1), U-shaped holder (1-2) and spring (1-6) on the right dial indicator ⑦ by hex wrench 2 mm ④. (see picture 1)
 - Then, assemble roller (1-3), sex bolt (1-4) and mating screw (1-5) on U-shaped holder (1-2) by 2 hex wrenches 3 mm ⑤. (see picture 2)
- Assemble the lateral measuring set ② on dial indicator ⑦.
 - Remove the contact point of the left dial indicator ⑦.
 - Assemble M2.5 screw (1-1), L-bracket (2-5) on the left dial indicator ⑦ by hex wrench 2 mm ④. (see picture 3)
 - Assemble M3 flat head screw (2-4), washer (2-1), deep groove ball bearing (2-2) and barrel nut (2-3) on L-bracket (2-5) by hex wrench 2 mm ④ and slotted screwdriver. (see picture 4)
- To assemble TB-PF22 on wheel truing stand, please refer to the instruction which comes with TB-PF30, TB-PF35 and TB-PF36 originally for further assembly and operation.

Be sure to loosen the knob (3-2) before adjusting the all-purpose arms ③ for fear of breaking the inside joint

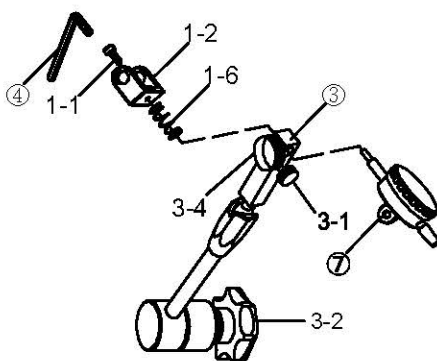

(Picture 1)

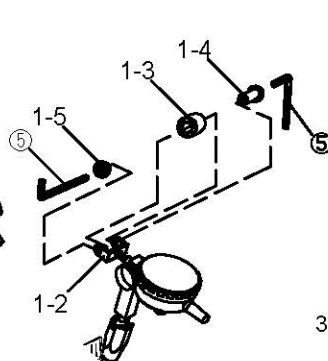

(Picture 2)

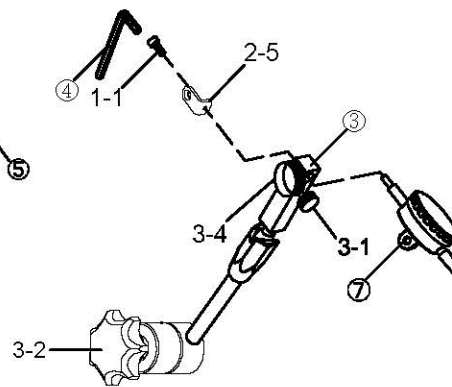

(Picture 3)

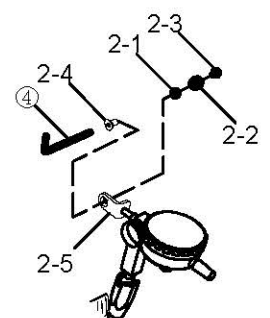

(Picture 4)

1 零件名稱及數量

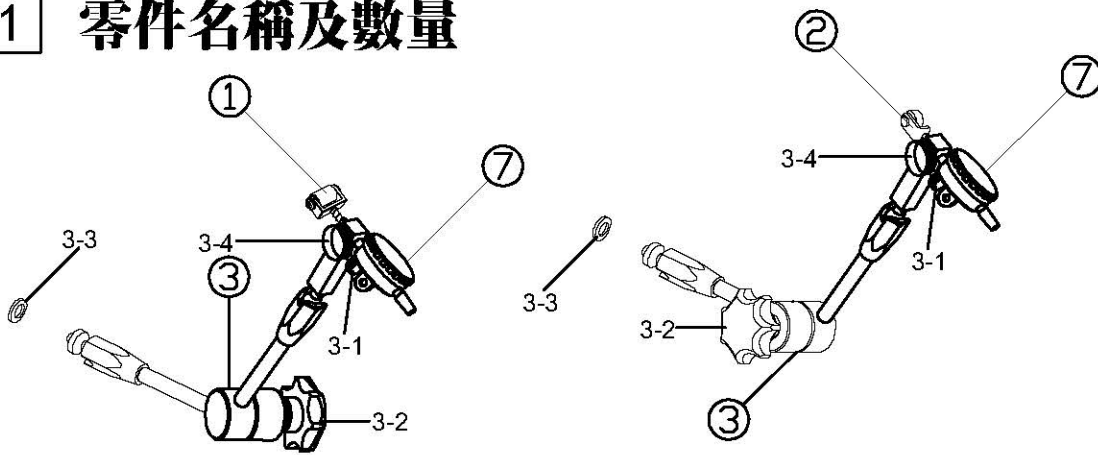

編號	名稱	數量
①	正圓測量座組	1
1-1	螺絲M2.5	1
1-2	U型托架	1
1-3	滾輪	1
1-4	對鎖螺絲(母)	1
1-5	對鎖螺絲(公)	1
1-6	彈簧	1
②	扁擺測量座組	1
1-1	螺絲M2.5	1
2-1	華司	1
2-2	深溝滾珠軸承	1
2-3	培林固定軸	1
2-4	皿型螺絲M3	1
2-5	培林固定板	1
③	萬向錶座	2
3-1	微調鈕	2
3-2	錶座旋鈕	2
3-3	墊圈	2
3-4	百分錶旋鈕	2
④	六角扳手 2 mm	1
⑤	六角扳手 3 mm	2
⑥	螺帽M8	2
⑦	百分錶	2

①正圓測量座組 (此區內零件一個袋子包裝)
 (1-1) 螺絲M2.5*1
 (1-2) U型托架*1
 (1-3) 滾輪*1
 (1-4) 對鎖螺絲(母)*1
 (1-5) 對鎖螺絲(公)*1
 (1-6) 彈簧*1

②扁擺測量座組 (此區內零件一個袋子包裝)
 (2-1) 華司*1
 (2-2) 深溝滾珠軸承*1
 (2-3) 培林固定軸*1
 (2-4) 皿型螺絲M3*1
 (2-5) 培林固定板*1 (1-1)螺絲M2.5*1

(工具一個袋子包裝)
 ④六角扳手 2 mm*1
 ⑤六角扳手 3 mm*2

2 組裝步驟

- 先鬆開百分錶旋鈕(3-4)，將兩個百分錶⑦分別固定於萬向錶座③上，並旋緊百分錶旋鈕(3-4)。(如圖一所示)
- 組裝正圓測量座組①於百分錶⑦上。
 2-1.將右側百分錶⑦探針拆下。
 2-2.使用六角扳手 2 mm④，將螺絲M2.5(1-1)、U型托架(1-2)與彈簧(1-6)組裝於右側百分錶⑦上。(如圖一所示)
 2-3.使用兩隻六角扳手 3 mm⑤，組裝滾輪(1-3)、對鎖螺絲(母)(1-4)與對鎖螺絲(公)(1-5)於U型托架(1-2)上。(如圖二所示)
- 組裝扁擺測量座組②於百分錶⑦上。
 3-1.將左側百分錶⑦探針拆下。
 3-2.使用六角扳手 2 mm④，將螺絲M2.5(1-1)、培林固定板(2-5)組裝於左側百分錶⑦上。(如圖三所示)
 3-3.使用六角扳手 2 mm④與一字扳手，組裝皿型螺絲M3(2-4)、華司(2-1)、深溝滾珠軸承(2-2)與培林固定軸(2-3)於培林固定板(2-5)上。(如圖四所示)
- 欲組裝TB-PF22於校正台上，請參照原購買之輪圈校正台(TB-PF30, TB-PF35, TB-PF36)所附的說明書，進行組裝及操作。

! 調整萬向錶座③前，請務必先放鬆錶座旋鈕(3-2)，否則將導致萬向錶座關節處損壞

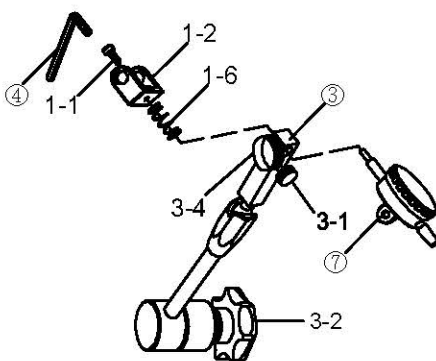

(圖一)

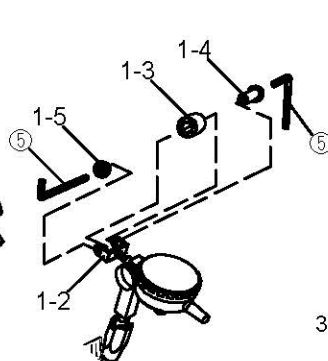

(圖二)

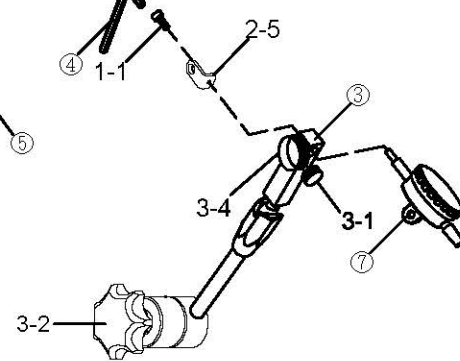

(圖三)

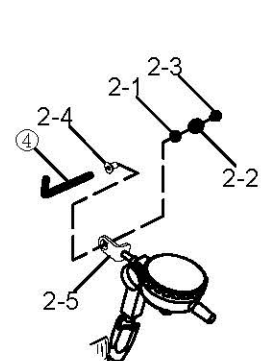

(圖四)