

1 Parts description

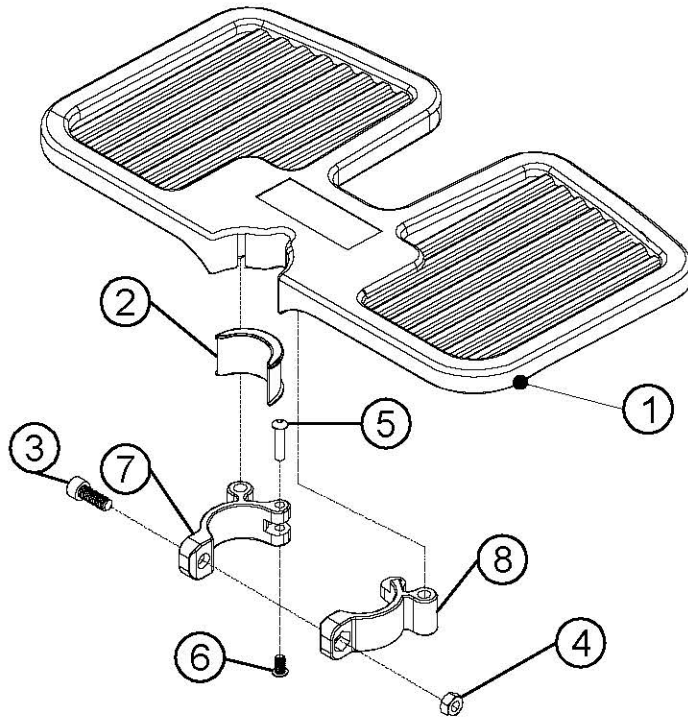

NO.	PART	Q'TY
①	Tray	1
②	Spacer	1
③	Bolt M8	1
④	Nut M8	1
⑤	Sex bolt	1
⑥	Mating screw	1
⑦	Mating clamp	1
⑧	Flange clamp	1

2 Assembly

1. Assemble mating clamp ⑦ and flange clamp ⑧ together, insert sex bolt ⑤ into the end of clamp and fasten the mating screw ⑥ by tightening it up.
2. Find the appropriate position on support tube, and use bolt M8 ③ and nut M8 ④ to fasten.
3. Place spacer ② into the clamp set.
Note: place spacer ② only for tube diameter of 38mm. It is unnecessary to place spacer on tube diameter of 44.5mm.
4. Combine the clamp ⑦⑧ with the tray and complete the assembly. (see picture 1)

This item suits for most of Super B storage stands and work stand.

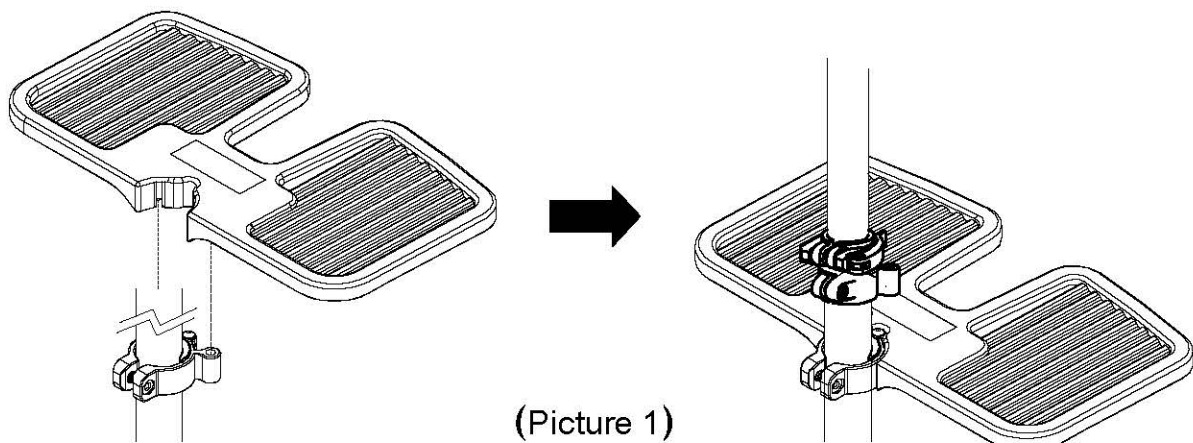

1 零件數量及名稱

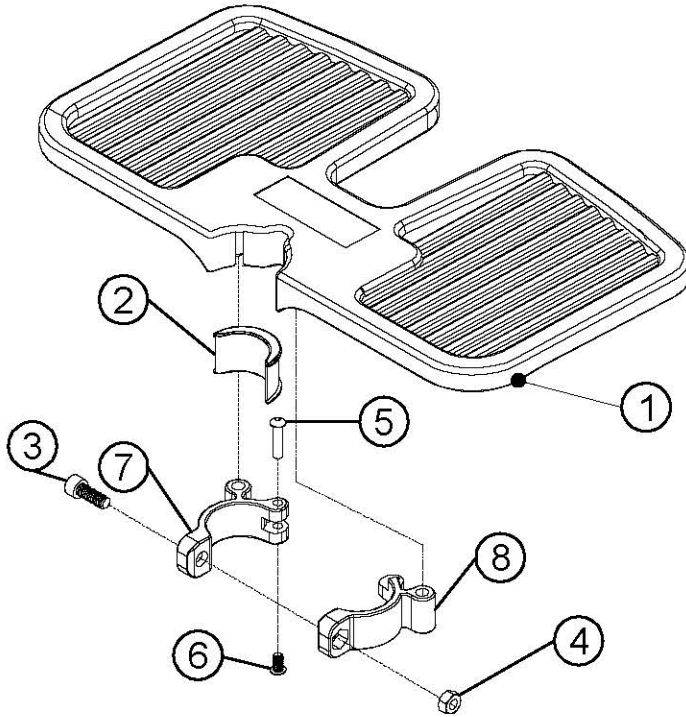

編號	名稱	數量
①	置物盤	1
②	墊片	1
③	六角螺絲M8	1
④	螺帽M8	1
⑤	對鎖螺絲(母)	1
⑥	對鎖螺絲(公)	1
⑦	雙耳管束(母)	1
⑧	雙耳管束(公)	1

2 組裝步驟

1. 將雙耳管束(母)⑦和雙耳管束(公)⑧組合在一起，尾端插入對鎖螺絲(母)⑤，再用對鎖螺絲(公)⑥鎖緊固定。
2. 在鋼管上找適當的位置夾住，前端插入六角螺絲M8③，再用螺帽M8④固定。
3. 管束墊片②放入雙耳管束組⑦⑧內。
注意：直徑38mm之管徑需放入管束墊片②，直徑44.5mm之管徑則不需放入。
4. 雙耳管束組⑦⑧的耳朵與置物盤①底部結合即可完成組裝。(如圖一所示)

可搭配大部分的Super B置車架與修理架使用。

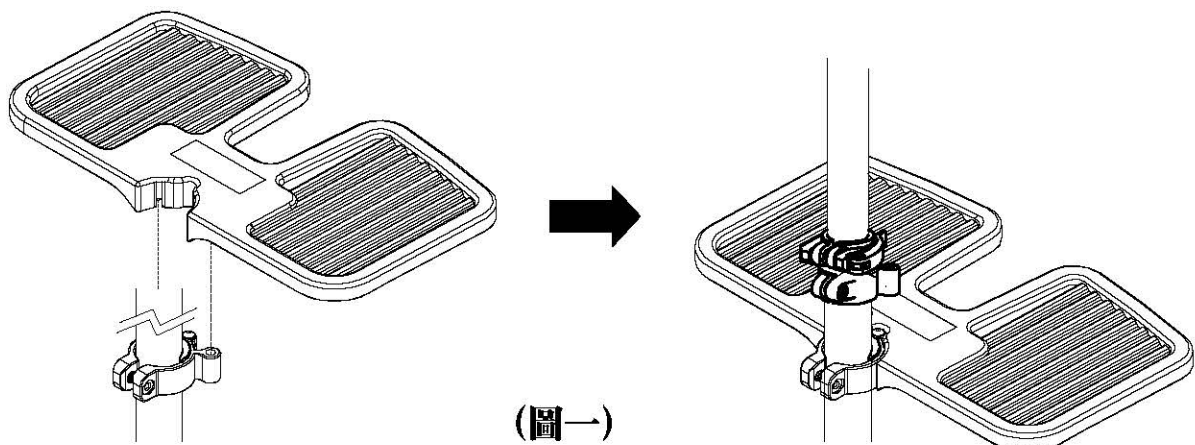

(圖一)